

# Side Door Sill Trim Plate Package Installation (Instruction ID: 84446044)

## Installation Instructions Part Number

84446044

**Note:** Please review the entire procedure before trying to perform it.

**Note:** If vehicle was built before 8/3/2020, the BCM will need to be programmed to enable sill plate light function. You do not need to call the Techline before reprogramming. Refer to step 31.4 for programming instructions.

### Kit Contents

Qty	Description
4	Illuminated Sill Plate Assembly
1	Wiring Harness Pkg (Contains Harness ASM (qty 1) and Wire Tie Straps (qty 16))

### Recommended Tools

- Flat Bladed Plastic Trim Tool
- 2mm Width Flat Screwdriver
- 0.8mm Width Flat Screwdriver
- Push-in Retainer Puller
- Electrical Tape
- 7mm and 10mm Socket
- Trim Removal Tools
- Small Ratchet
- Wire Puller
- Connector Service Tool EL-38125-58 (Cadillac Vehicles only) see video

### Click Image For Video

© 2021 General Motors. All rights reserved.



### Procedure

**IMPORTANT: DO NOT REMOVE, DISASSEMBLE, DISCONNECT OR DISTURB ANY SEAT BELT ATTACHMENTS OR ANCHORS.**

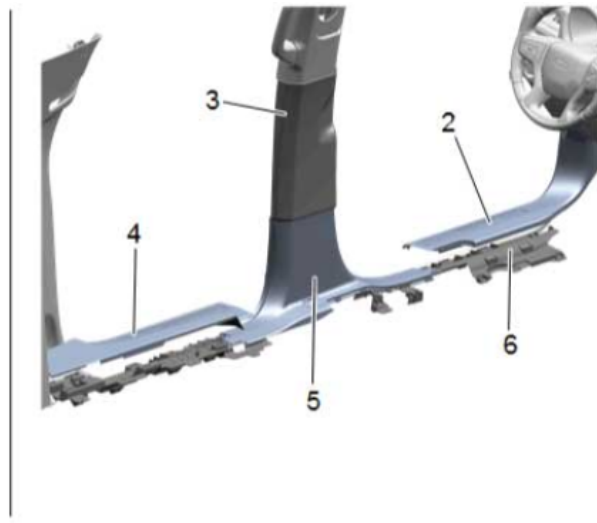
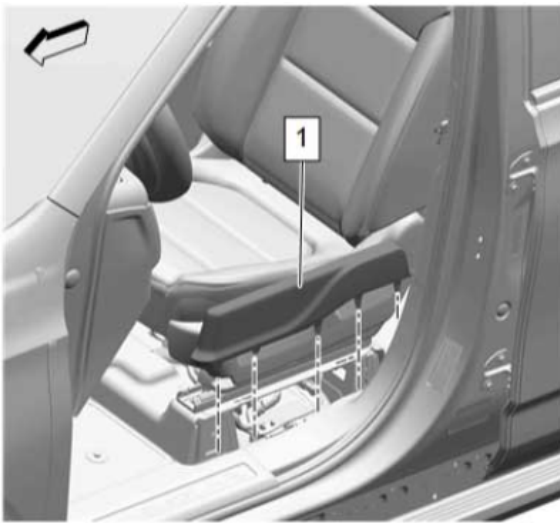

1. Move the front seats to the furthest rearward position.
2. Remove trim in the order as shown: front seat adjuster track finish cover (1), left and right front side door sill garnish moldings (2), left and right center pillar upper trim panels (3), left and right rear side door sill garnish moldings (4) and partially remove the left and right center pillar lower trim panels (5). Refer to [Center Pillar Lower Trim Panel Replacement](#) in Vehicle Service Manual.  
**Note:** The center lower trim panels do not need to be completely removed from vehicle. They just need to provide access for routing the wiring harness.
3. Remove the left and right front harness sill protectors (6).
4. Remove the left and right front floor console extension panels. Refer to [Front Floor Console Extension Panel Replacement - Left Side](#) and [Front Floor Console Extension Panel Replacement - Right Side](#) in Vehicle Service Manual.
5. Remove the left and right instrument panel lower insulators. Refer to [Instrument Panel Lower Trim Panel Insulator Replacement - Left Side](#) and [Instrument Panel Lower Trim Panel Insulator Replacement - Right Side](#) in Vehicle Service Manual.
6. Remove front floor mats and reposition front carpet as necessary.

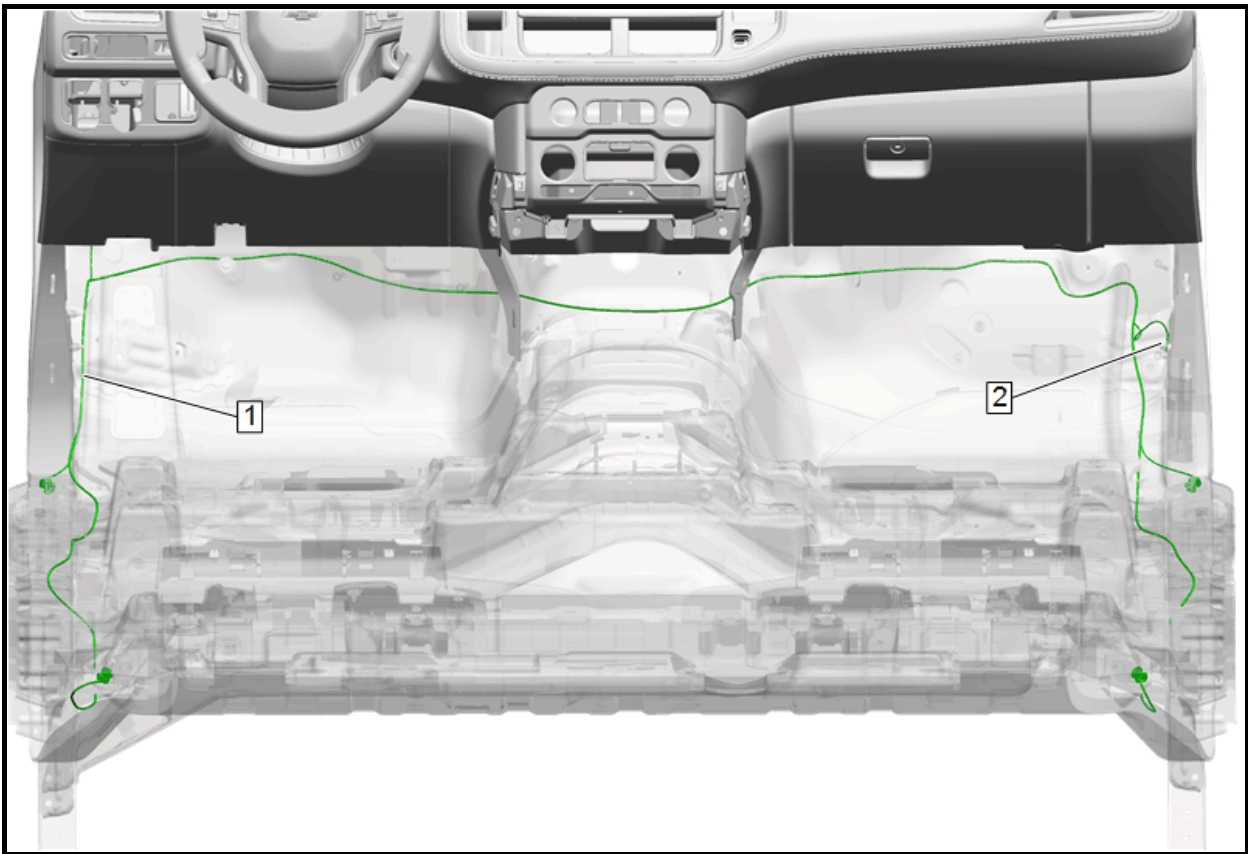

7. Route wiring harness through the vehicle as shown.

7.1. Begin by spreading out the harness to understand how it is routed through the vehicle. The harness will route from the driver side, to the passenger side, near the top edge of the carpet. The ground eyelet attaches in the passenger side cowl and the two loose wires attach to the BCM harness under the driver side of I/P.

7.2. Route the harness (1) loosely across the dash panel near the top of the carpet with the BCM connections on driver side under I/P, and ground (2) on the right side.

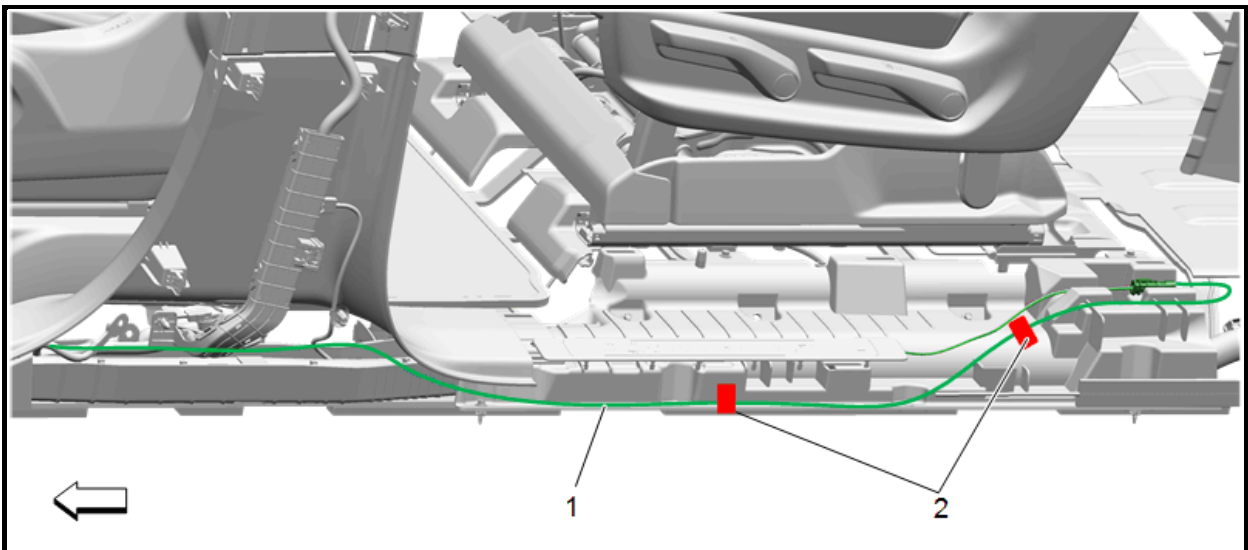

8. Route wiring harness (1) through the vehicle as shown. Tape wiring harness in locations (2) indicated.

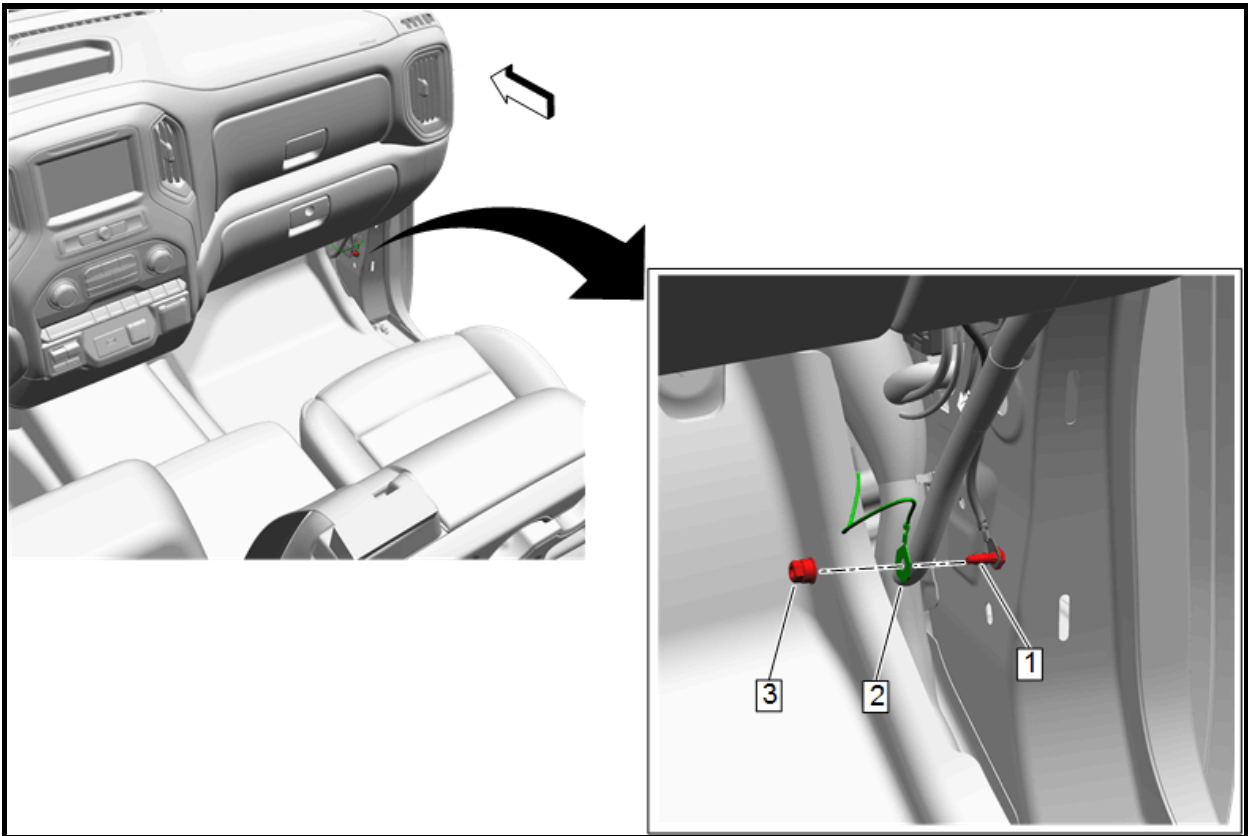

9. Locate the ground stud (1) on the passenger side cowl. If equipped with more than one stud, choose the stud with only one eyelet.
10. Remove the ground nut (3) and install the illuminated sill plate harness ground eyelet (2) to the ground stud (1).  
**Caution:** Use the correct fastener in the correct location. Replacement fasteners must be the correct part number for that application. Fasteners requiring replacement or fasteners requiring the use of thread locking compound or sealant are identified in the service procedure. Do not use paints, lubricants, or corrosion inhibitors on fasteners or fastener joint surfaces unless specified. These coatings affect fastener torque and joint clamping force and may damage the fastener. Use the correct tightening sequence and specifications when installing fasteners in order to avoid damage to parts and systems.
11. Reinstall the ground nut (3) and tighten to 25 N.m (18 lb in).

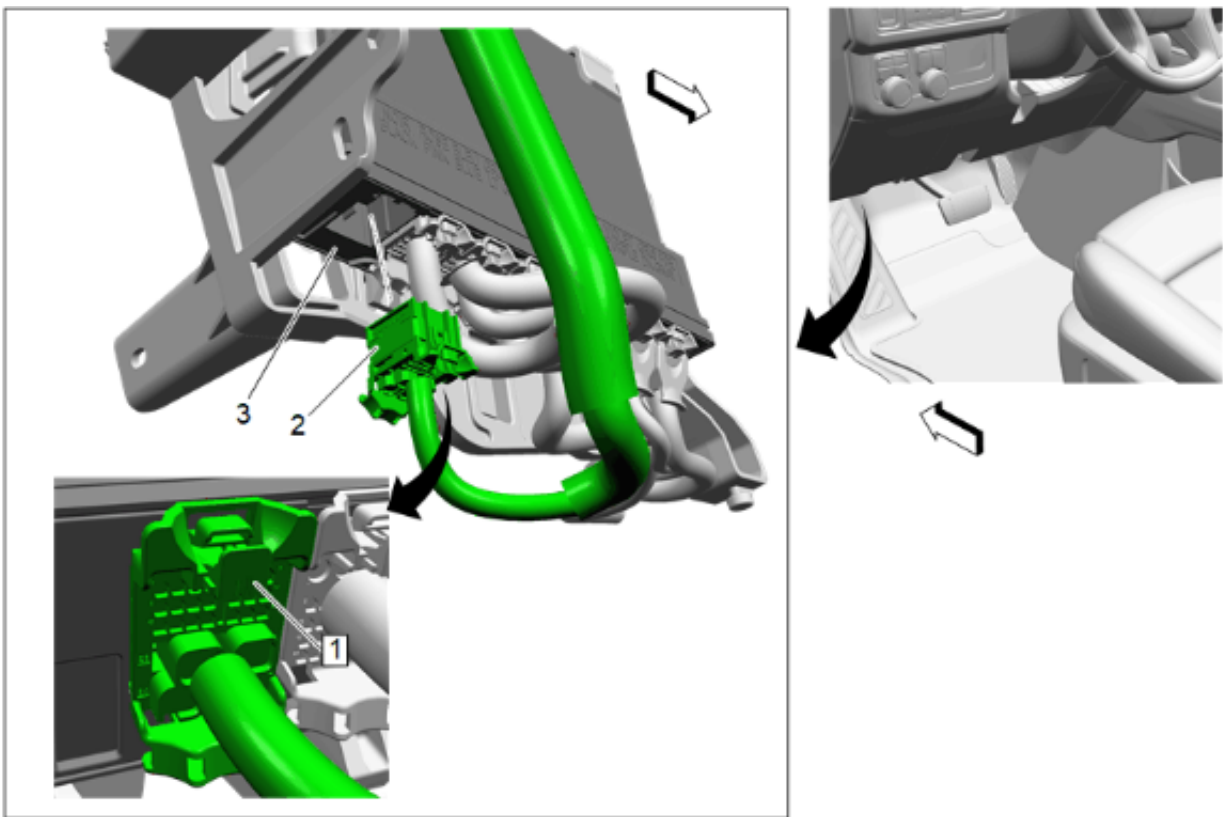

12. Locate the BCM (3) on the driver side of the vehicle, under the I/P. Locate BCM connector (2) X1 BLACK and open the CPA (1) (connector position assurance). Disconnect BCM connector (2) X1 BLACK from the BCM.

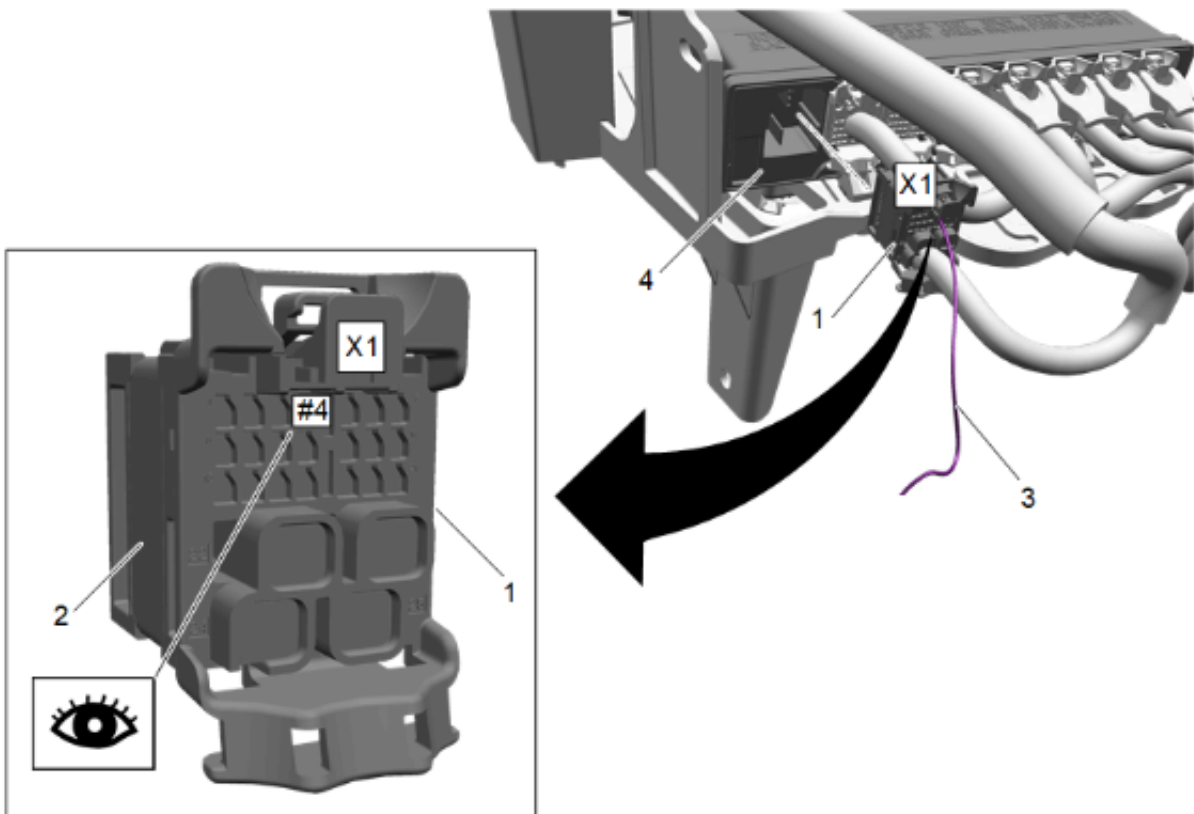



13. Disengage the ISL (2) (Isolated Secondary Lock) on BCM connector X1 (1).

14. **For Cadillac Models:**

14.1. Locate cavity #4 on the removed connector (1).

14.2. There will be a wire in this cavity. Use service tool EL-38125-58 to remove the existing wire according to Service procedure. The existing wire in cavity 4 performs no function and its removal will not disable any part of the vehicle. Insert the purple wire (3) from the provided harness into cavity 4 and make a soft pull to make sure it is seated.

14.3. Re-engage the ISL (2) (Isolated Secondary Lock) on BCM connector X1 (1).

14.4. Tape harness to the existing bundle within 25 mm of rear of connector.

14.5. Re-connect connector X1 (1) to the BCM (4) and re-engage the CPA (connector position assurance) clip.

15. **FOR CHEVROLET AND GMC MODELS:**

15.1. Insert the purple wire (3) from the supplied harness into cavity 4. Make a soft pull to make sure it is seated.

15.2. Re-engage the ISL (2) (Isolated Secondary Lock) on BCM connector X1 (1).

15.3. Tape harness to the existing bundle within 25 mm of rear of connector.

15.4. Re-connect connector X1 (1) to the BCM (4) and re-engage the CPA (connector position assurance) clip.

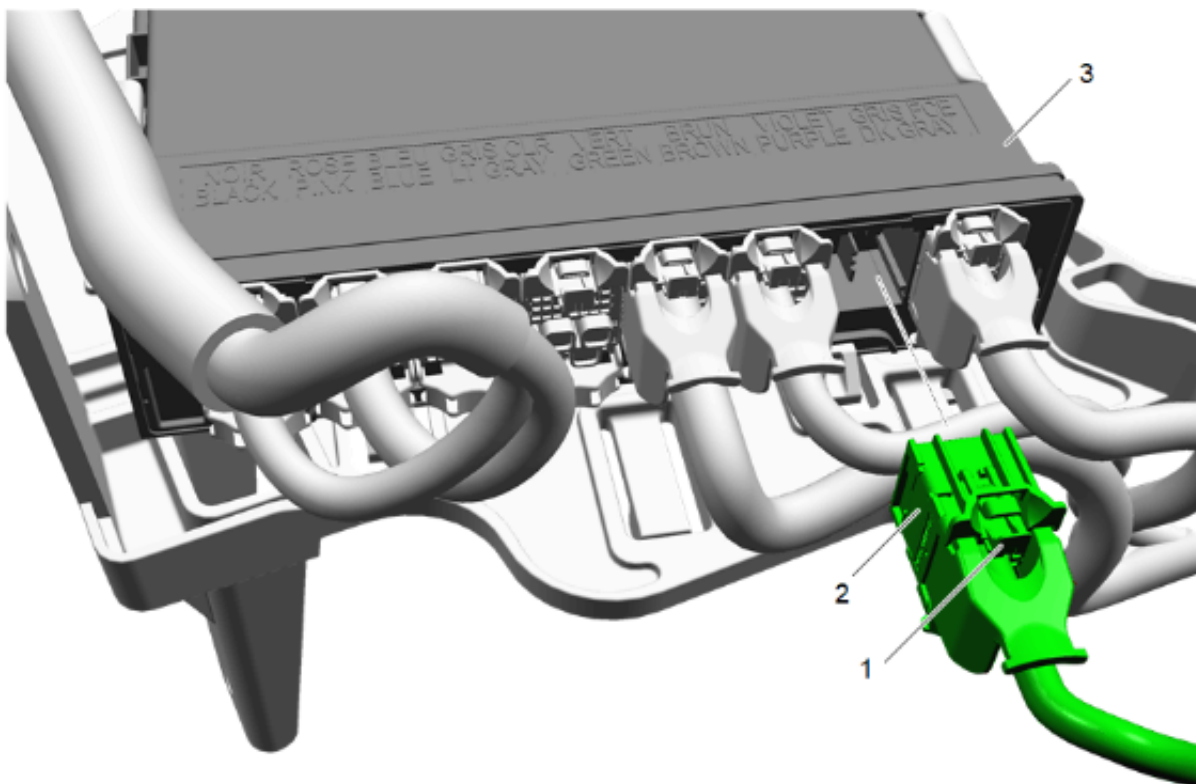

16. Locate the BCM (3) on the driver side of the vehicle, under the I/P. Locate BCM connector (2) X7 PURPLE and open the CPA (1) (connector position assurance). Disconnect BCM connector (2) X7

PURPLE from the BCM.

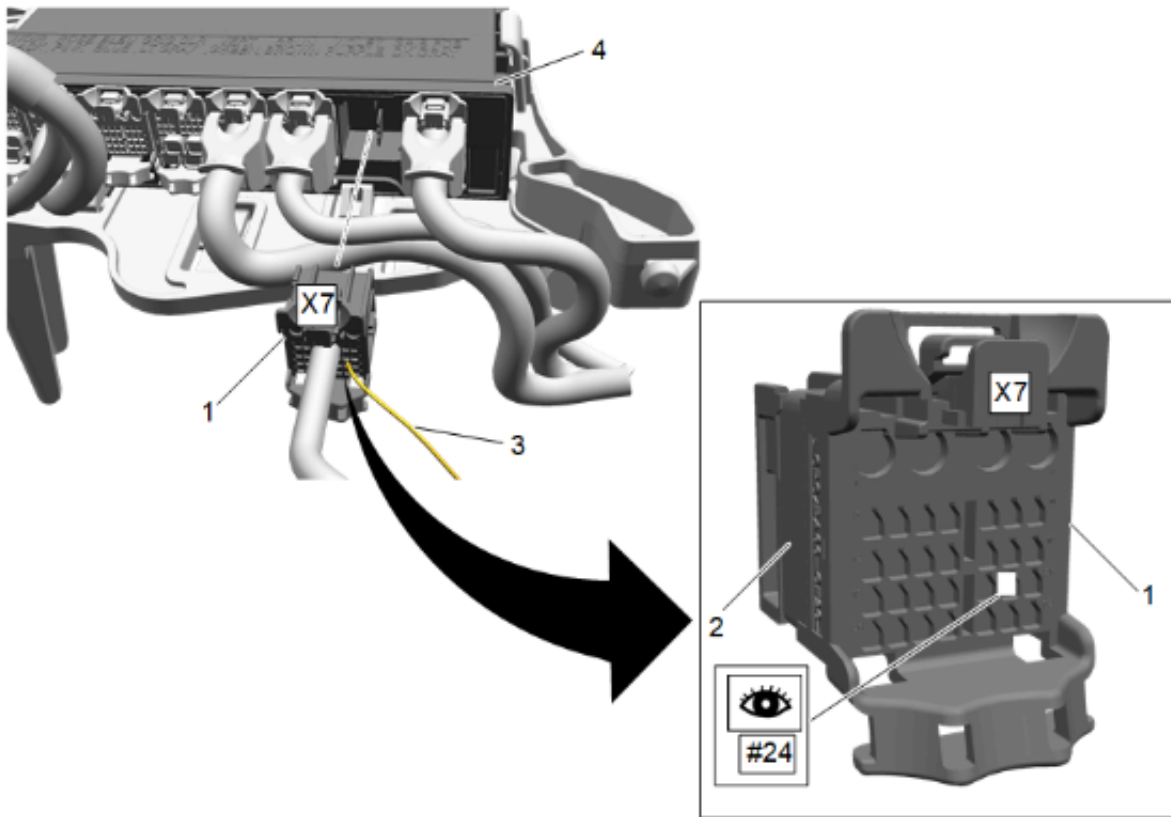

17. Disengage the ISL (2) (Isolated Secondary Lock) on BCM connector X7 (1).
18. Locate cavity #24 on the removed connector (1). No wire is there, plug the ckt 4783 yellow (3) and make a soft pull to make sure it is seated.
19. Re-engage the ISL (2) (Isolated Secondary Lock) on BCM connector X7 (1).
20. Tape harness to the existing bundle within 25 mm of rear of connector.
21. Re-connect connector X7 (1) to the BCM (4).

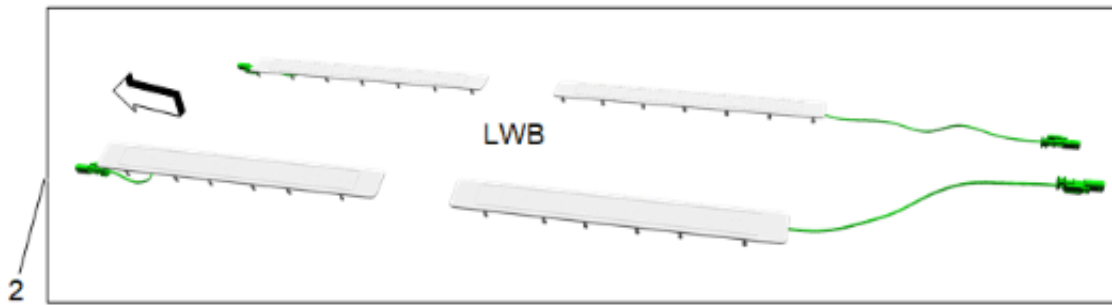

22. Prior to installing new sills, please note the wire length and positions.

- Short Wheelbase (1).
- Long Wheelbase (2).

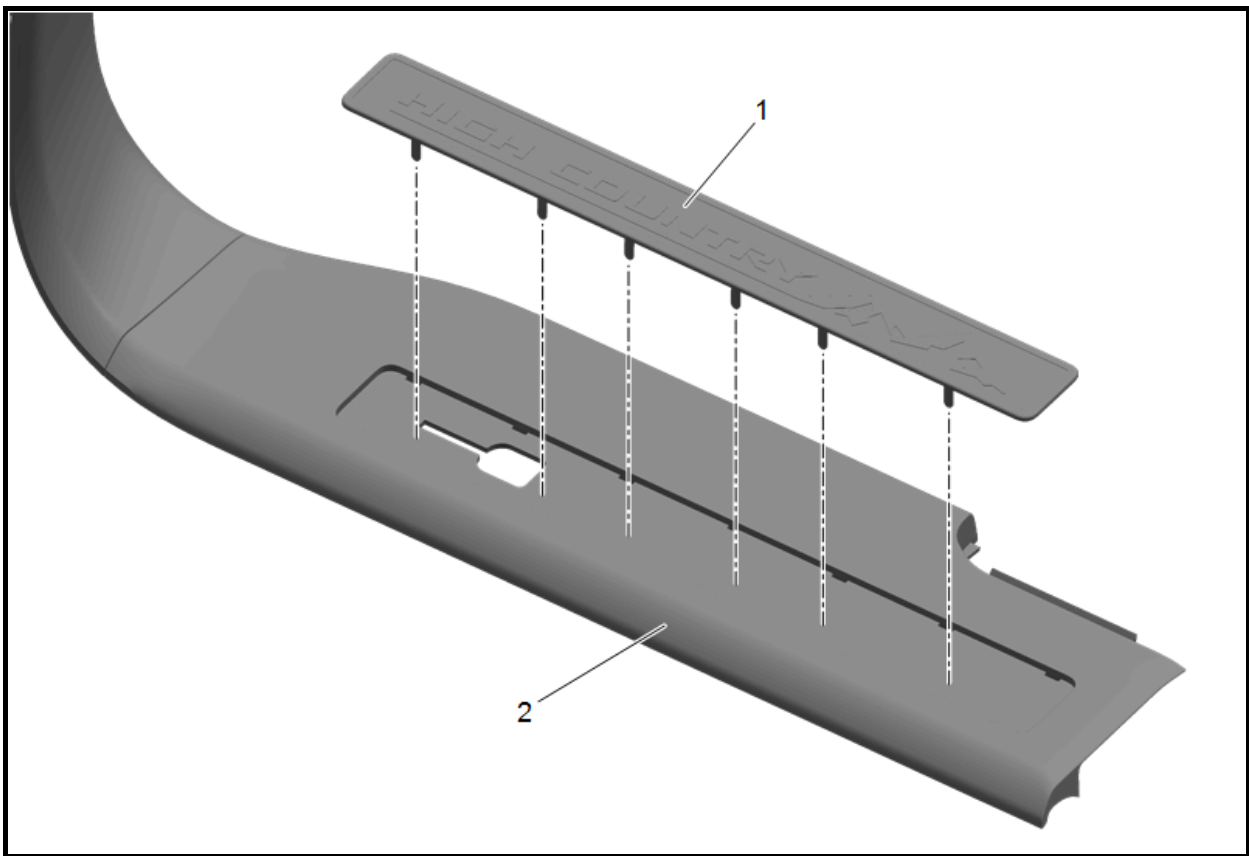

23. Remove the sill center (1) from the sill garnish molding (2).

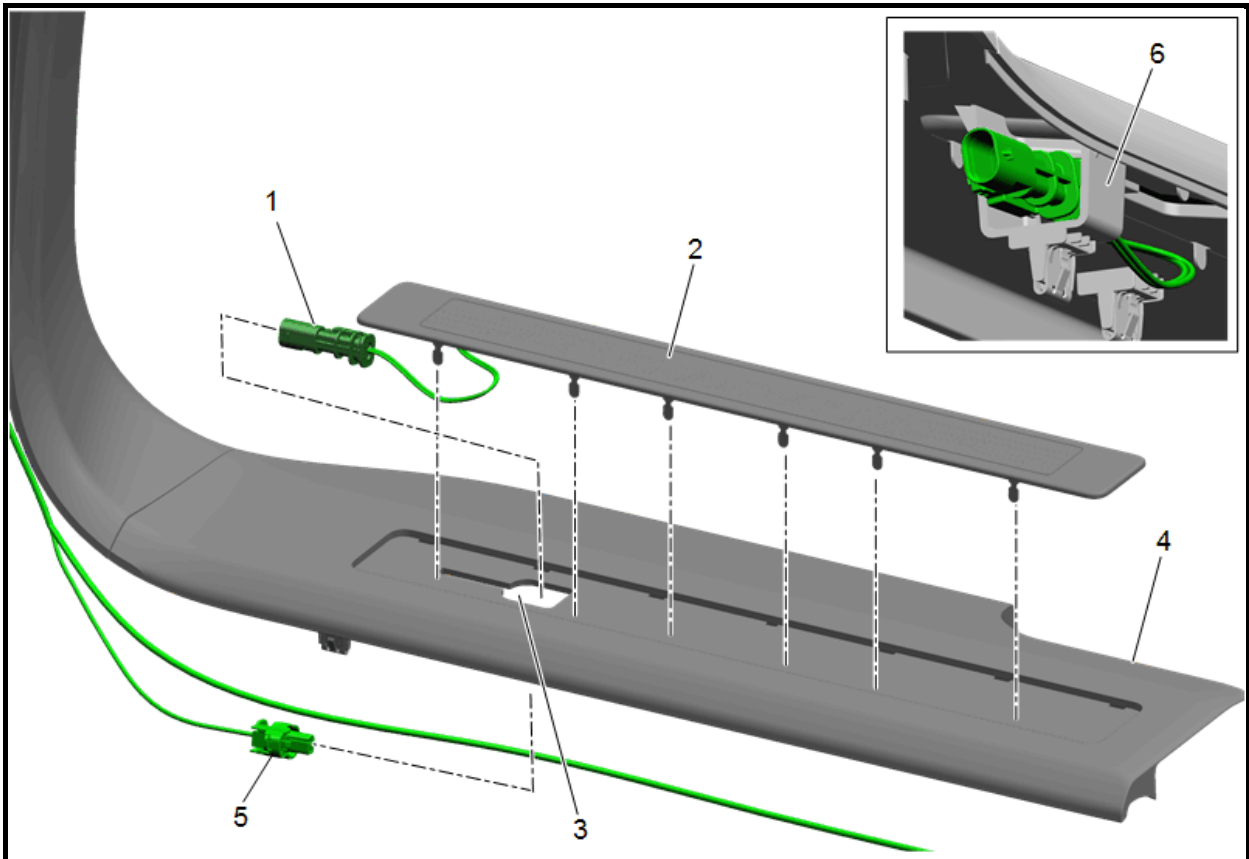



24. Insert the electrical connector (1) of the illuminated sill (2) through the opening (3) in the sill garnish molding (4). Connect the electrical connector (1) into the connector housing (6) of the sill garnish molding.
25. Pull harness through and install the illuminated sill (2) to the sill garnish molding (4) engaging the center tabs on the under side of sill garnish molding.
26. Plug in the electrical connector (1) of the illuminated sill garnish molding to the illuminated sill wire harness (5). Do not fully install the harness sill protector and illuminated sill garnish molding at this time.

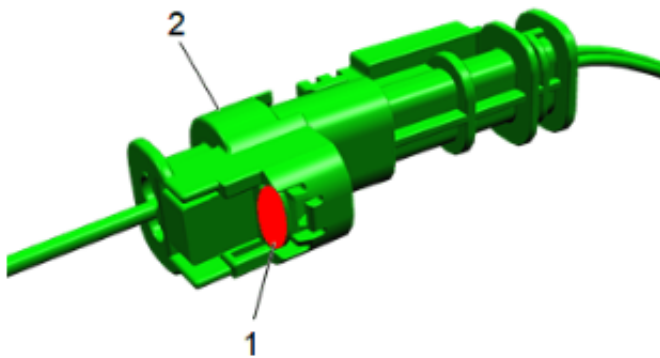

27. Make sure to push the red CPA tab (1) into place on each connector.

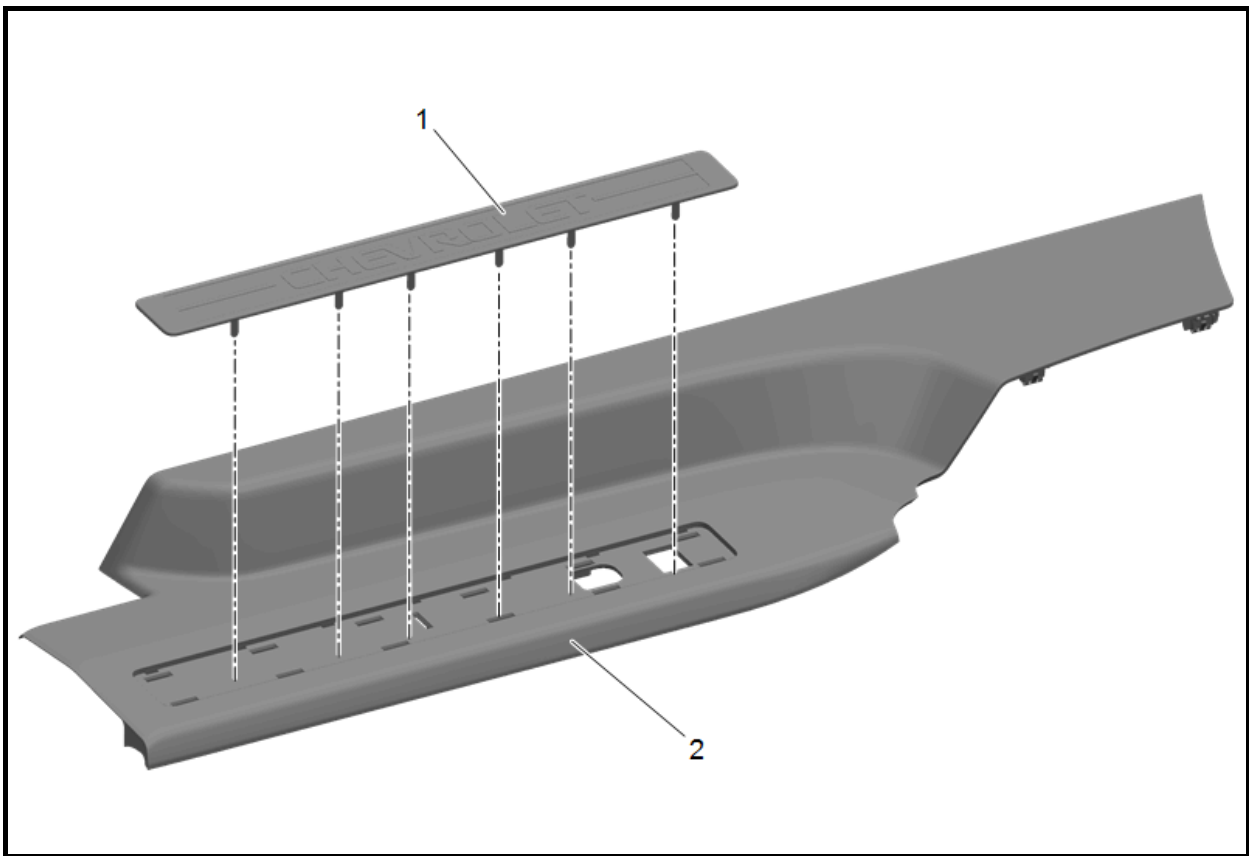

28. Remove the sill center (1) from the sill garnish molding (2).

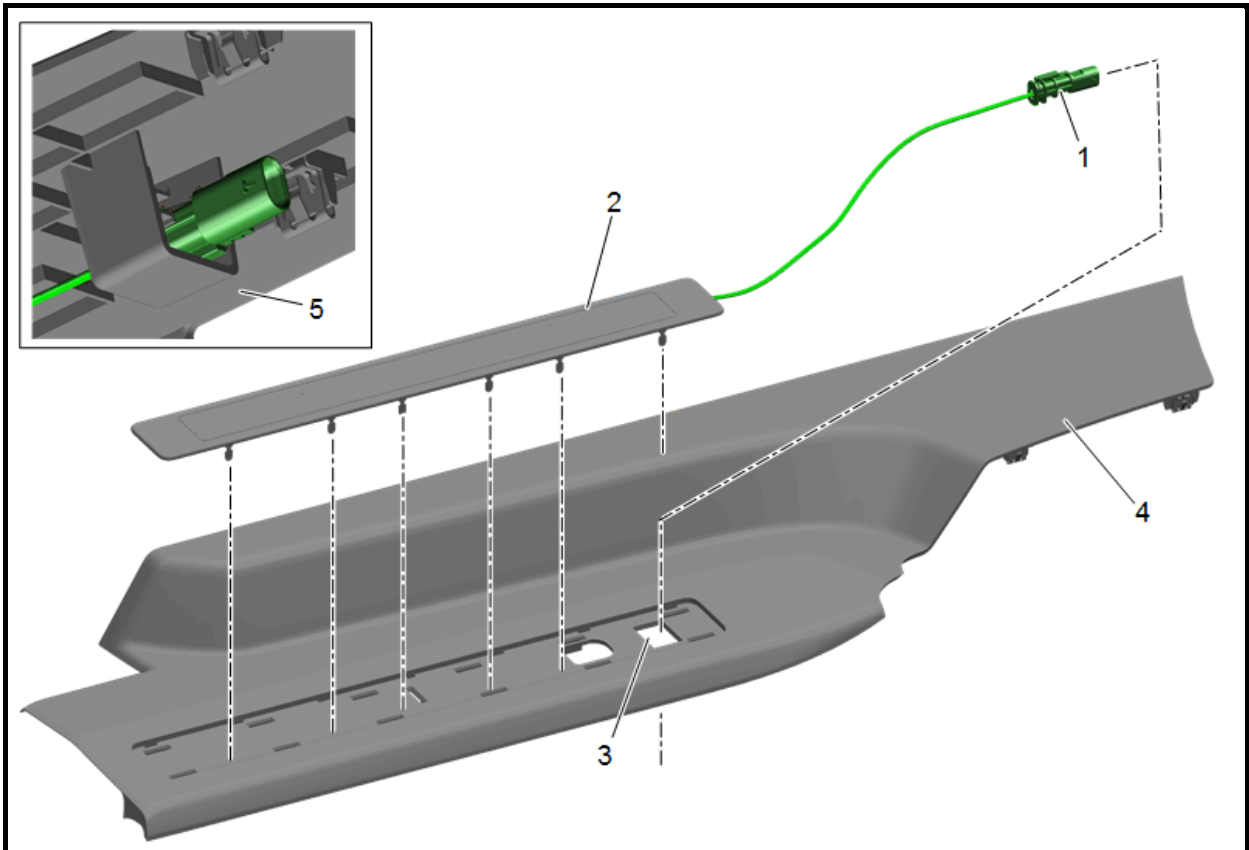



29. Insert the electrical connector (1) of the illuminated sill (2) through the opening (3) in the sill garnish molding (4).
30. Pull harness through and install the illuminated sill (2) to the sill garnish molding (4) engaging the center tabs on the under side of sill garnish molding. Connect the electrical connector (1) into the connector housing (5) of the sill garnish molding

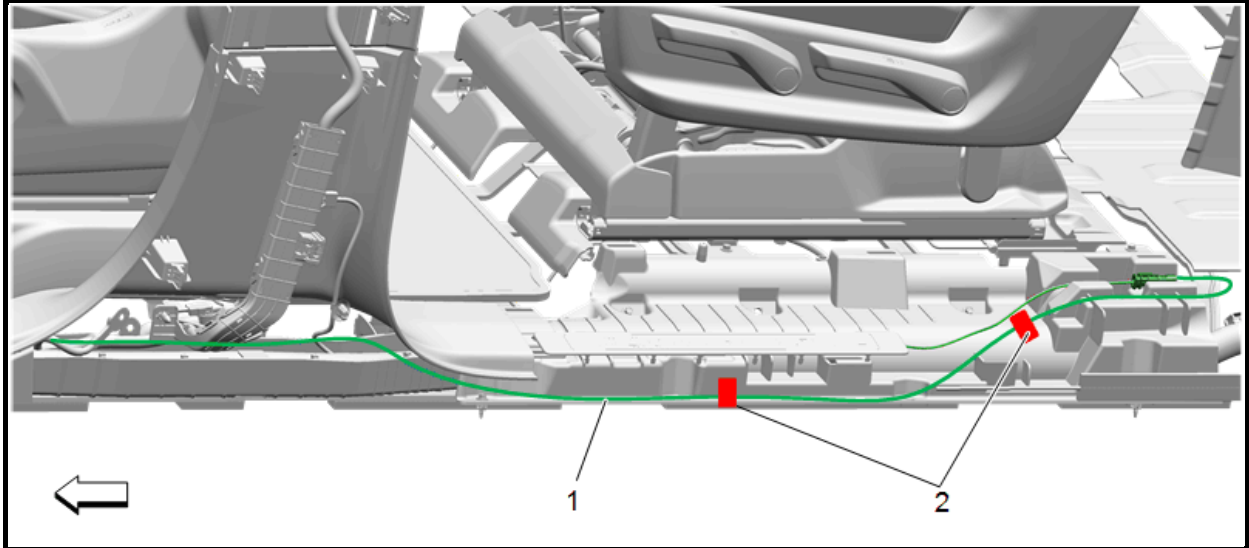

31. Plug in the electrical connector of the illuminated sill garnish molding to the illuminated sill wire harness (1). Tape wire (2) to sill garnish molding. Do not fully install the harness sill protector and illuminated sill garnish molding at this time.

**Note:** If required, excess cable can be tied with main bundle using extra cable ties provided.

#### **Check Operation of the Illuminated Sill Plates**

31.1. Verify all disconnected electrical connections are re-connected.

31.2. Close all doors

31.3. Open each door, door garnish molding will illuminate when in night mode.

**Note:** If vehicle was built before 8/3/2020, the BCM will need to be reprogrammed to enable sill plate light function. Refer to [K9 Body Control Module: Programming and Setup](#) in Vehicle Service Manual.

31.4. If the sill garnish molding does not light up, cover the ambient light sensor on the top center of the instrument panel, ensure that the ambient lighting is ON in the Vehicle Personalization menu, if applicable (Vehicle->lighting-> ambient light-> ON), check the ground and BCM cavities as well as other connections at the illuminated sill garnish moldings. Make sure that the headlamp switch is in AUTO and the headlamps are ON. If the dimmer switch is in the lowest setting, the sill moldings will be off.

31.5. Check to see if the courtesy lights are working.

31.6. Verify that the illuminated sill garnish moldings are operating correctly.

31.7. Pull back the carpet and route the harness along the floor about 50 to 75 mm below the top of the carpet, from side to side.

31.8. Use tie straps, as required, to keep harness secure and from being seen. 16 tie straps are provided in the harness package.

- 31.9. Secure the sill harness protector to the rocker panel with the previously removed screws. Tighten screws to 2.5 N.m (22 lb in).
- 31.10. Align the illuminated sill garnish molding snap features to the holes on the sill harness protector and forward vertical wall.
- 31.11. Firmly press into place until the illuminated sill garnish molding is fully seated.
- 31.12. Repeat for the remaining illuminated sill plates on the vehicle.

### **Re-install Carpet and Trim**

1. Check clips on removed trim panels, replace clips if necessary.
2. Tuck wire harness behind carpet and trim.
3. Reposition carpet, and reinstall removed trim panels.

**Note:** Verify all wires are neatly secured, not pinched and not visible, tie straps should be used as necessary to keep harness secured and out of sight.